

Bennett Release – Titles Est. November 2025

Lot	Address	Area m ²	Frontage	Price	BAL	Zoning
1	Treeby Road	523	17.4	HOLD - \$430,000	LOW	R30
2	Treeby Road	451	15	\$404,000	LOW	R30
14	Bennett Street	450	15	SOLD	LOW	R30
16	Bennett Street	375	12.5	SOLD	LOW	R30
17	Bennett Street	450	15	SOLD	LOW	R30
18	Bennett Street	450	15	SOLD	LOW	R30
24	Bennett Street	375	12.5	SOLD	12.5	R30
26	Bennett Street	375	12.5	SOLD	12.5	R30
28	Bennett Street	375	12.5	SOLD	12.5	R30
31	Bennett Street	375	12.5	SOLD	12.5	R30
32	Bennett Street	375	12.5	SOLD	12.5	R30
36	Angove Road	345	15	HOLD - \$355,000	12.5	R30
37	Angove Road	340	cnr (15)	SOLD	12.5	R30
38	Dulverton Ave	375	12.5	\$372,000	12.5	R30
39	Dulverton Ave	375	12.5	HOLD - \$372,000	12.5	R30
40	Dulverton Ave	375	12.5	SOLD	12.5	R30
41	Dulverton Ave	375	12.5	HOLD - \$372,000	12.5	R30
42	Dulverton Ave	315	10.5	SOLD	12.5	R30
47	Dulverton Ave	375	12.5	SOLD	12.5	R30

All lots include front landscaping and boundary fencing.

\$2,000 Deposit required at contract signing. Pricing subject to change without notice.
Bushfire Attack Level Rating may apply to some lots. Pricing and details correct as of 14th July 2025.
Titled = Ready to build straight after settlement! * = BAL subject to additional setback requirements



For more information contact
Jelena Schmidt on 0460 307 260
catenaestate.com.au



Selina Release – Titles Est. July 2025

Lot	Address	Area m ²	Frontage	Price	BAL	Zoning
3	Cronin Way	527	15	HOLD - \$412,000	LOW	R30
4	Cronin Way	485	16.69	HOLD - \$410,000	LOW	R30
12	Bennett Street	445	cnr (15)	\$390,000	LOW	R30
73	Albina Avenue	438	cnr (15)	\$390,000	12.5	R30
84	Selina Street	375	12.5	SOLD	LOW	R30
86	Selina Street	375	12.5	HOLD - \$372,000	LOW	R30
97	Albina Avenue	320	12.61	SOLD	LOW	R30
114	Albina Avenue	410	cnr (15)	\$392,000	LOW	R30

All lots include front landscaping and boundary fencing.

\$2,000 Deposit required at contract signing. Pricing subject to change without notice.
Bushfire Attack Level Rating may apply to some lots. Pricing and details correct as of 14th July 2025.
Titled = Ready to build straight after settlement! * = BAL subject to additional setback requirements



For more information contact
Jelena Schmidt on 0460 307 260
catenaestate.com.au



Bennett Release

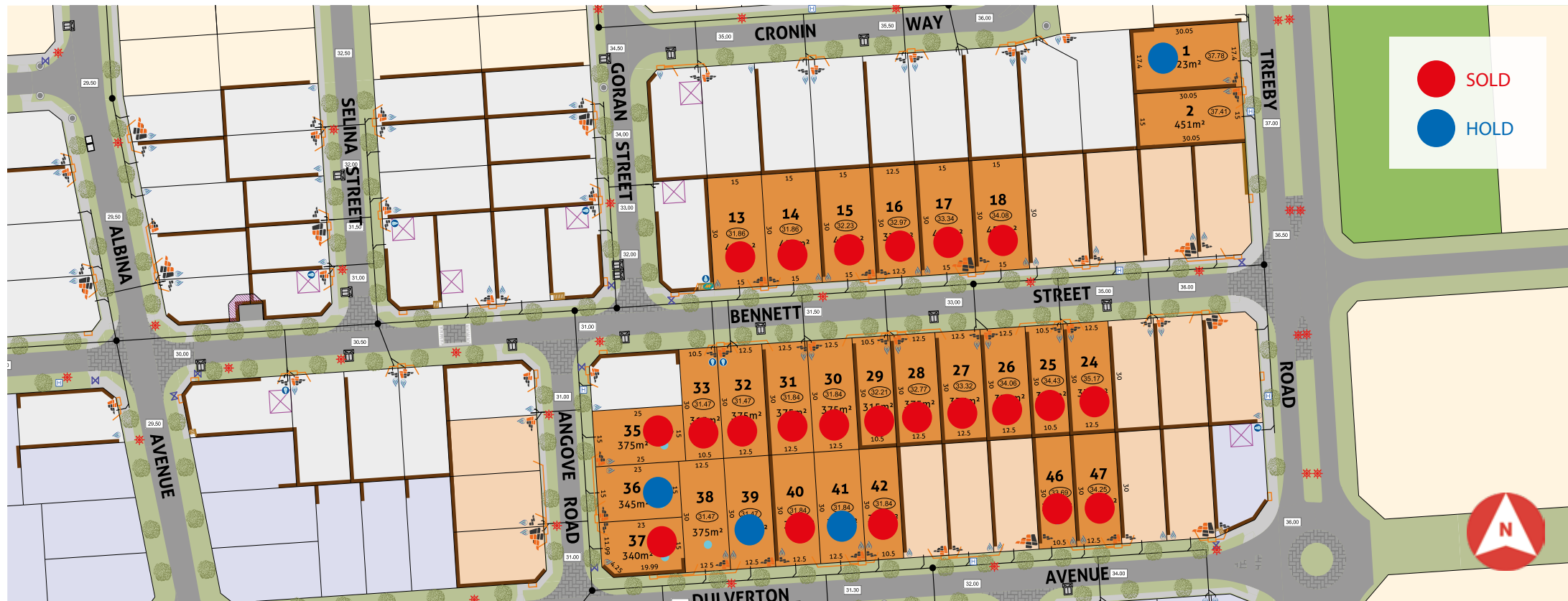

Legend

- | | | | | |
|---|--|--|--|---|
| Bennett Release | Future Release | Previous Release | Future Development | Other Development |
| Brick Paving | Footpath | Retaining Wall | Reverse Cantilever Wall | Stairs |
| Lot Level | Speed Bump | Uni Mini | Western Power Housing Connection | Below Ground Power Transformer Site with 129BA Fire Separation Restrictive Covenant |
| Street Light | NBN Connection | Side Entry Pit | Drainage Grate | Drainage Manhole |
| Sewer Housing Connection Manhole | Indicative BAL 12.5 | Water Connection | Below Ground Water Service Pit | Water Hydrant |
| Water Valve | Designated Garage Location | | | |



Selina Release



Legend



Ace Release	Selina Release	Future Release	Other Development
Brick Paving	Uni Mini	Western Power	Side Entry Pit
Footpath	Housing Connection	Below Ground Power	Drainage Grate
Retaining Wall	Transformer Site with 129BA Fire Separation Restrictive Covenant	Sewer Housing Connection Manhole	Drainage Manhole
Stairs	Street Light	NBN Connection	Water Connection
Lot Level			Below Ground Water Service Pit
Speed Bump			Water Hydrant
			Water Valve
			Designated Garage Location

